

Bikehangar Versions

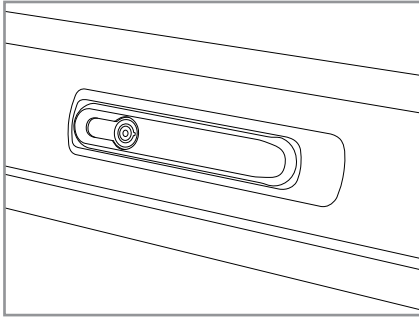

V1
Silver Lock Handle

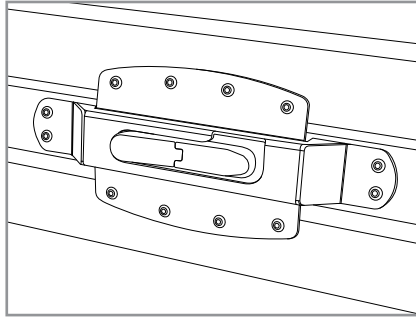

V2
Shielded Lock Handle

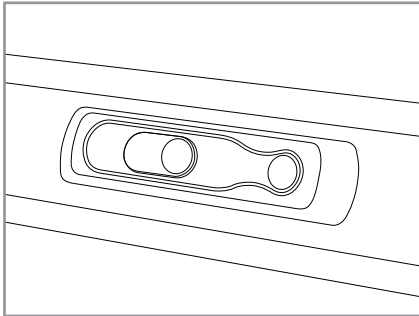

V3
Black Lock Handle

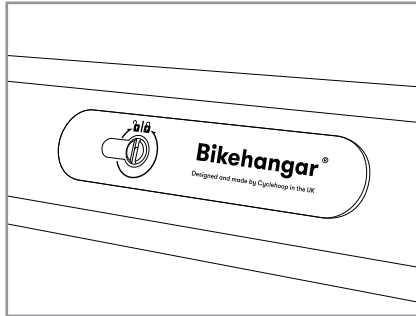

V4
Handleless Key



How to securely lock your bike

When parking your bike inside the Bikehangar, use a good quality D-lock. A poor quality lock at the lower end of the market can be easily cut through or bolt cropped in seconds. It certainly pays to invest in the best quality lock you can afford.

For maximum protection you can use two locks of different types (a D-lock and robust chain and padlock is ideal).

Use your lock to catch the wheels, frame and stand. Fill up as much of the space within the D-lock as possible with the bicycle.

How to use the V1 Bikehangar

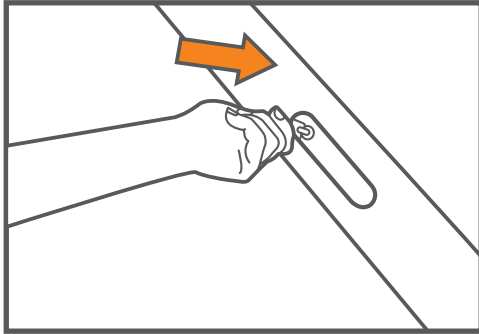

1. Insert key.

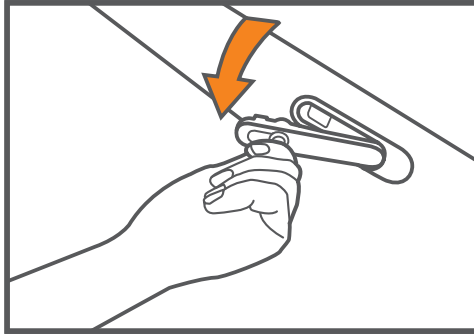

2. Turn key to release lever.

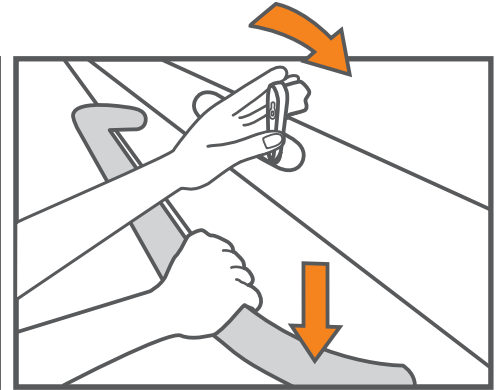

3. Push down on long handle and turn lever. Door will lift automatically.

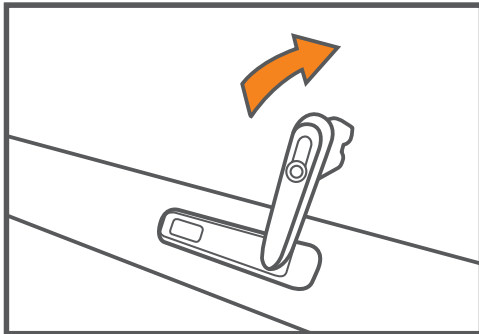

1. Ensure lever is in the open position.
Pull the door down to close.

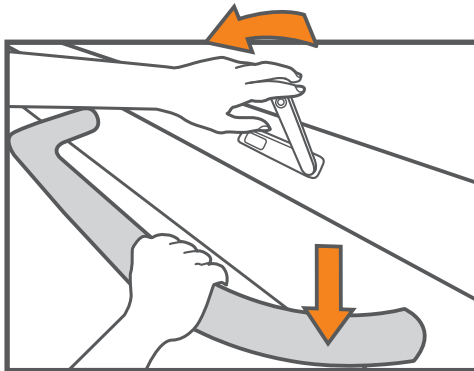

2. Close the door and push down on the handle before turning the lever.

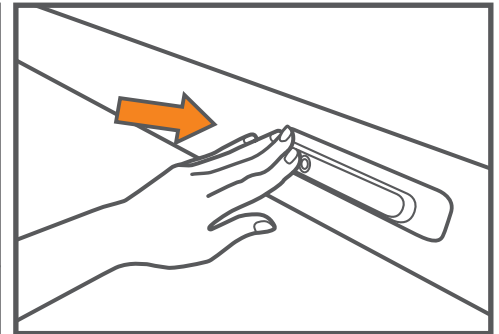

3. Push in the lever and check the door is locked by pulling upwards.

How to use the V2 Bikehangar

Opening

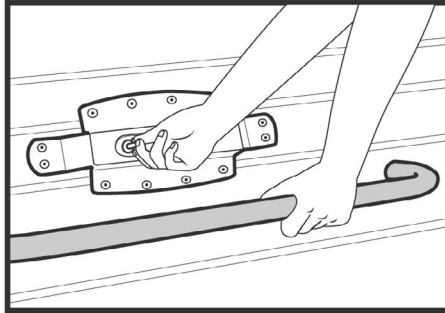

1. Lift black lock flap. Insert and turn key to release black lever. Pull lever out, remove key.

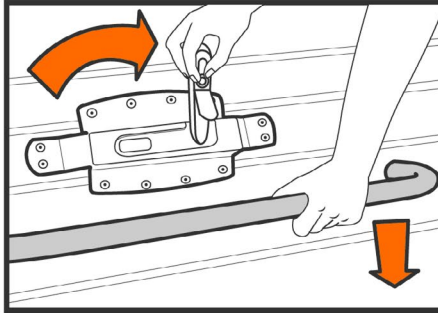

2. Press down on grey handle, turn black lever clockwise. Lift grey handle lightly.

Closing

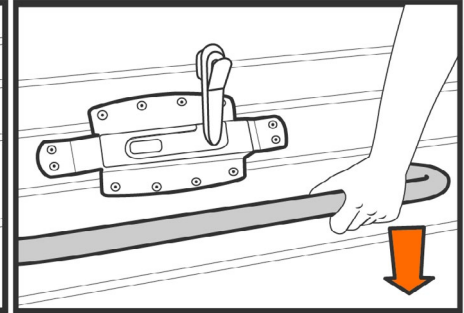

1. Close door by pushing down firmly on grey handle until door slams closed.

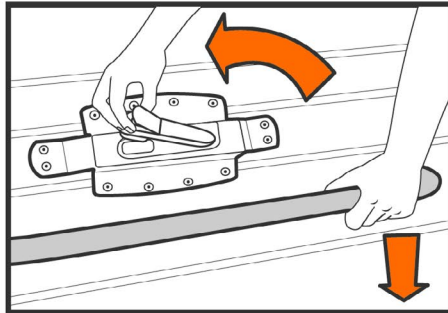

2. Continue pressing down on handle and return black lever to horizontal position.

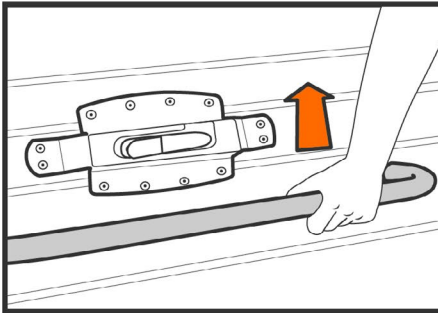

3. **IMPORTANT:** Pull up on grey handle to check door is closed before locking.

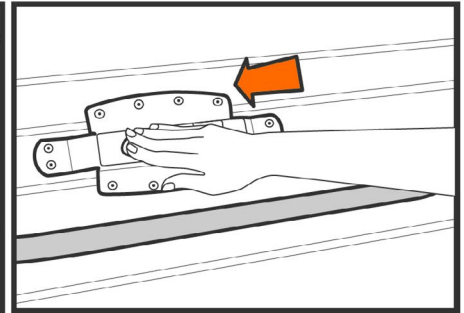

4. Push black lever in until lock clicks. Rest black lock flap against locking shield.

How to use the V3 Bikehangar

Opening

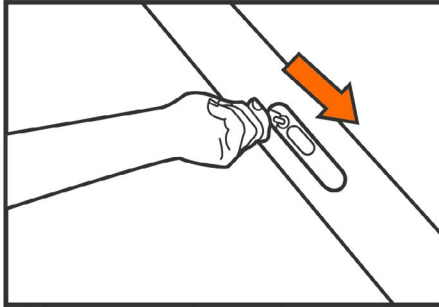

1. Slide lock cover right and insert key.

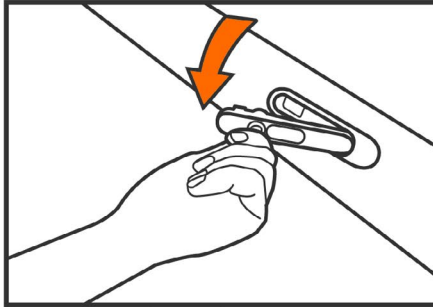

2. Turn key anticlockwise to release lever. Return key clockwise to remove it.

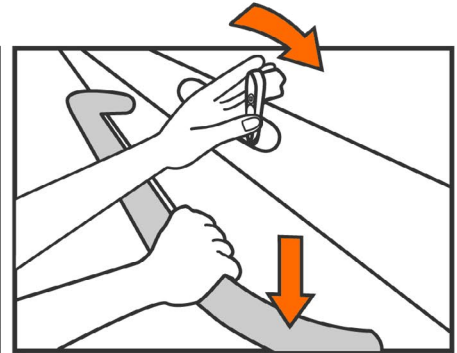

3. Press down on grey handle, turn lever clockwise into open position. Lift grey handle lightly.

Closing

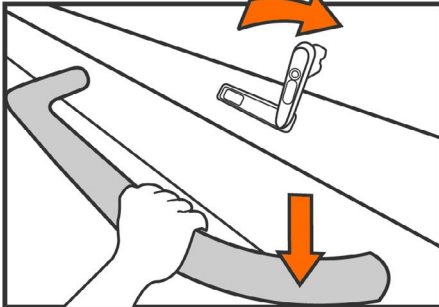

1. Close door by pushing down firmly on grey handle with lever in its open position.

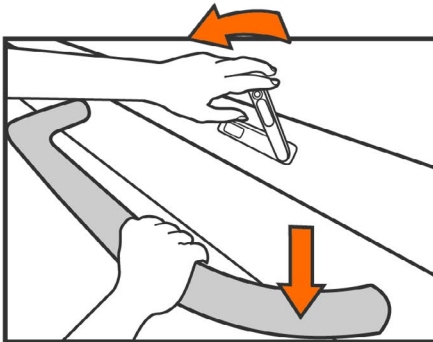

2. Continue pressing down on handle and return lever to horizontal position. **IMPORTANT:** Pull up on grey handle to check door is closed.

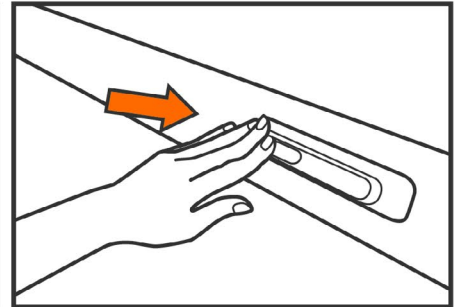

3. Push in lever firmly until lock securely clicks back into place. Return lock cover left.

How to use the V4 Bikehangar



Opening

1. Push down on the grey handle.
2. Turn the key 360 degrees clockwise to unlock the unit.
The key can be removed when in a vertical position.
3. Lift up on the grey handle lightly.

Closing

1. Check the door is not obstructed by one of the cycles.
2. Push down on the grey handle while locking the unit.
Turn the key 360 degrees anticlockwise to lock.
3. Pull up on the grey handle to check it is locked.



Scan here for video guidance, or
YouTube 'Bikehangar Guidance'

How to use the Bikelocker

1. When using the locker for the first time, adjust the wheel hook to the correct height so that there is minimal lifting required.
2. To adjust the hook, loosen the black handle slightly and slide the wheel hook to the correct position. Once a comfortable height is achieved you do not need to repeat this step again.

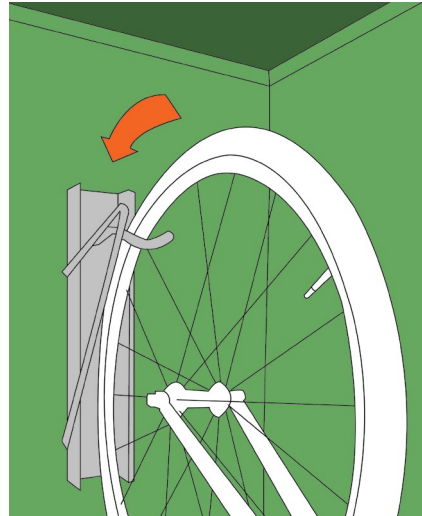

3. To store the bike, lift it onto the back wheel and roll the bike into the channel.
4. Lift the bicycle slightly to hook the front wheel into the locker.
5. To remove, pull the bike backwards and lift the front wheel off the hook.