

How to use the Bikehangar

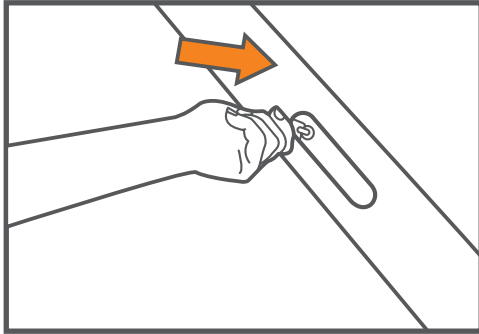

1. Insert key.

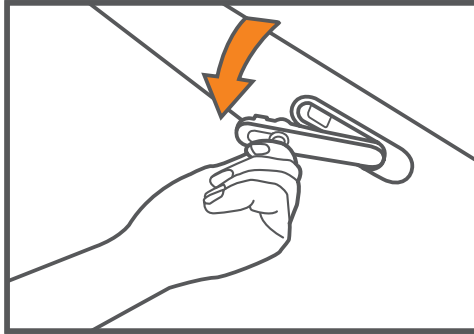

2. Turn key to release lever.

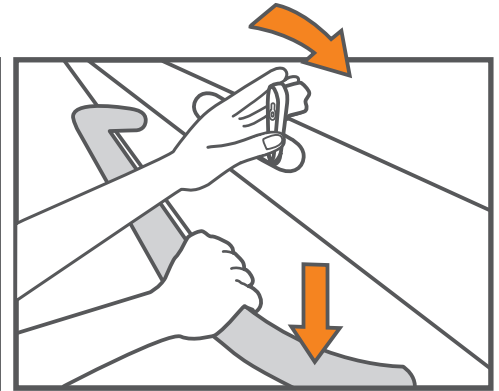

3. Push down on long handle and turn lever. Door will lift automatically.

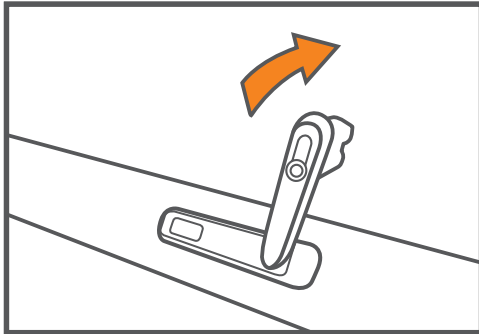

1. Ensure lever is in the open position.
Pull the door down to close.

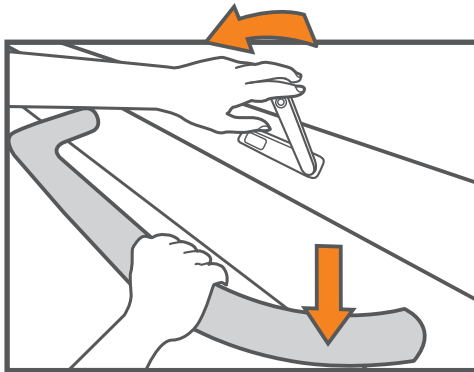

2. Close the door and push down on the handle before turning the lever.

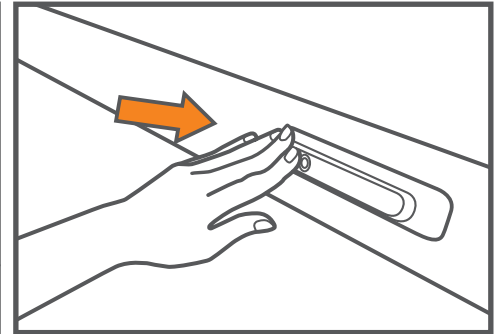

3. Push in the lever and check the door is locked by pulling upwards.

How to use the Bikelocker

1. When using the locker for the first time, adjust the wheel hook to the correct height so that there is minimal lifting required.
2. To adjust the hook, loosen the black handle slightly and slide the wheel hook to the correct position. Once a comfortable height is achieved you do not need to repeat this step again.

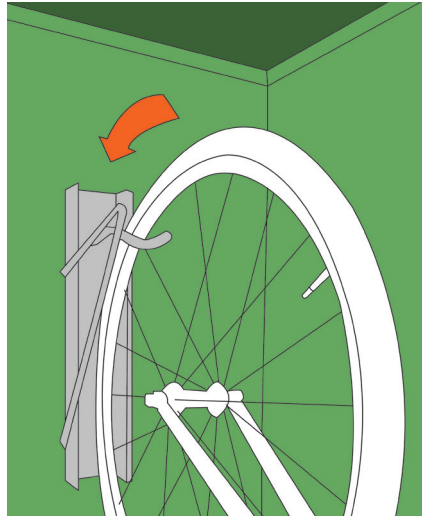
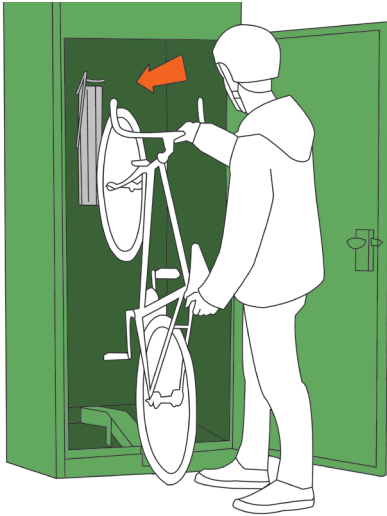

3. To store the bike, lift it onto the back wheel and roll the bike into the channel.
4. Lift the bicycle slightly to hook the front wheel into the locker.
5. To remove, pull the bike backwards and lift the front wheel off the hook.



How to securely lock your bike

When parking your bike inside the Bikehangar, use a good quality D-lock. A poor quality lock at the lower end of the market can be easily cut through or bolt cropped in seconds. It certainly pays to invest in the best quality lock you can afford.

For maximum protection you can use two locks of different types (a D-lock and robust chain and padlock is ideal).

Use your lock to catch the wheels, frame and stand. Fill up as much of the space within the D-lock as possible with the bicycle.